

# LANRE311210

## Installation Instructions

Tow Cable Kit for 2014 & Older John Deere® 9xx0R Series 4-Wheel Drive Tractors

# LANKOTA®

270 West Park Avenue  
Huron, SD 57350  
866-526-5682

# Numerical Parts List

<b>Part Numbers</b>	<b>Description</b>	<b>Qty</b>
LANJDTC102	Pin for JD Tow Cable	1
LANJDTC110A	Tow Cable with Spring & Bushing	1
LANJDTC124	Cable Guide for 2012-2014 9R Series	1
LANJDTC127	Cable Guide Spacer	6
LANRE311683	7/16" x 2.5" Lynch Pin	1
LANF257T	Double Split Shaft Collar	1
LANTC1771	Tow Cable Universal JD Stow Arm, Base	1
LANTC1772	Tow Cable Universal JD Stow Arm, Extension	1
LANTCT320856	Tow Cable Storage Pin	1
LANTCT160263	Cable Retaining Washer	1
RED21940	7/16" x 1.5" Lynch Pin	1
LANB918	7/8" x 4.5" Hex Bolt	4
LANFB910	7/8" x 2.5" Hex Bolt	4
LANFWS59	7/8" SAE Flat Washer	16
REDKRJ9	7/8" Top Lock Nut	8
LANFB816	3/4" x 4" Hex Bolt	2
LANFWS58	3/4" SAE Flat Washer	5
REDKRJG	3/4" Top Lock Nut	3

# Pictorial Parts List

				
LANJDTC102 (1)	LANJDTC110A (1)	LANRE311683 (1)	LANF257T (1)	LANTC1771 (1)
				
LANJDTC126 (1)	LANJDTC127 (6)	REDKRJ9 (8)	REDKRJG (3)	LANTC1772 (1)
				
LANTCR320856 (1)	LANTCT160263 (1)	RED21940 (1)	LANFWS58 (5)	LANFB816 (2)
				
LANB918 (4)	LANFWS59 (16)	LANFB910 (4)		

# Kit Installation

Tractor WITHOUT Front Weight Bracket:

**Refer to Figure 1**

1. Mount the cable stow base (LANTC1771) to the right side of the tractor frame with (4) 7/8" x 2.5" bolts (LANFB910), top lock nuts (REDKRJ9) and (8) flat washers (LANFWS59).

WITH or WITHOUT Front Weight Bracket:

**Refer to Figures 2 & 3**

2. Attach cable guide (LANJDTC126) to the inside of the tractor frame with (4) 7/8" x 4" bolts (LANB918), top lock nuts (REDKRJ9) and (8) flat washers (LANFWS59).

NOTES:

- Use (3) spacers (LANJDTC127) on each side of the main frame.
- On some tractors the cable guide may need to be mounted further forward due to interference with the oil filter. The cable guide may use the holes just behind the stow arm.

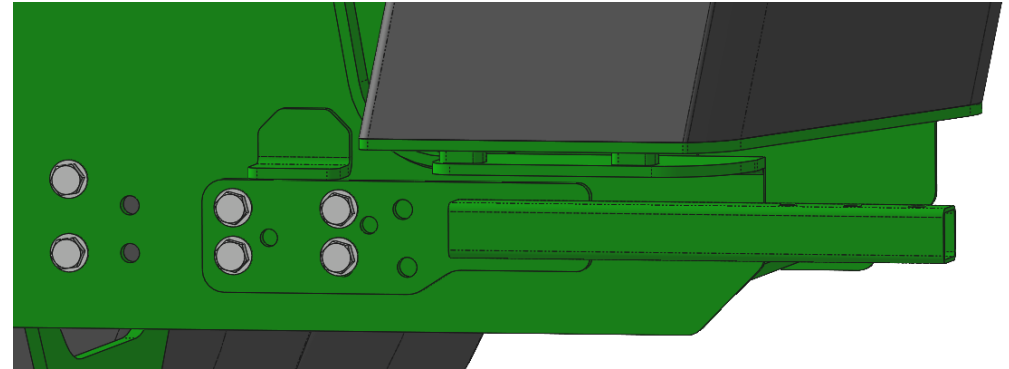

Figure 1



Figure 3





# Kit Installation

## Refer to Figures 4 & 5

3. Pull tow cable (LANJDTC110A) from the front, through the cable guide and back to the front of the draw bar.
4. Remove front draw bar pin by lifting up on the spring-loaded retainer and moving to the side. The draw bar pin can be stored in the other hole if desired.

## Refer to Figures 6 & 7

5. Put pin (LANJDTC102) through cable yolk and slide up into hole and secure with lynch pin (LANRE311683).



Figure 4



Figure 6



Figure 5



Figure 7

# Kit Installation

## Refer to Figures 8 & 9

6. Turn tractor so that it is at full lock to the right or left. Pull forward on cable until there is about a six inch valley in the middle of the cable.
7. Slide the washer and spring up tight against the cable guide and secure in place with lock collar (LANF257T) provided and tighten. This will keep the cable from dragging on the ground when turning.

Figure 8



Figure 9



For further technical assistance,

Call Lankota Inc. at:

1-866-526-5682



# Kit Installation

## Refer to Figures 10 & 11

8. Attach the tow pin (LANTCR320856) with a 3/4" washer and lock nut.
  - If your tractor **HAS A WEIGHT BRACKET**, mount it directly to your factory weight bracket.
  - For **NO WEIGHT BRACKET**: mount it to the stow arm (LANTC1772) and attach it to the previously installed base with the 3/4" bolts, washers and nuts. Use the set of holes that keep the cable taught and off the ground.

## Refer to Figure 12

9. Hang the front cable yolk from the stow pin, slide on the storage washer (LANTCT160263) and secure with lynch pin (RED21940).

Figure 10



Figure 11

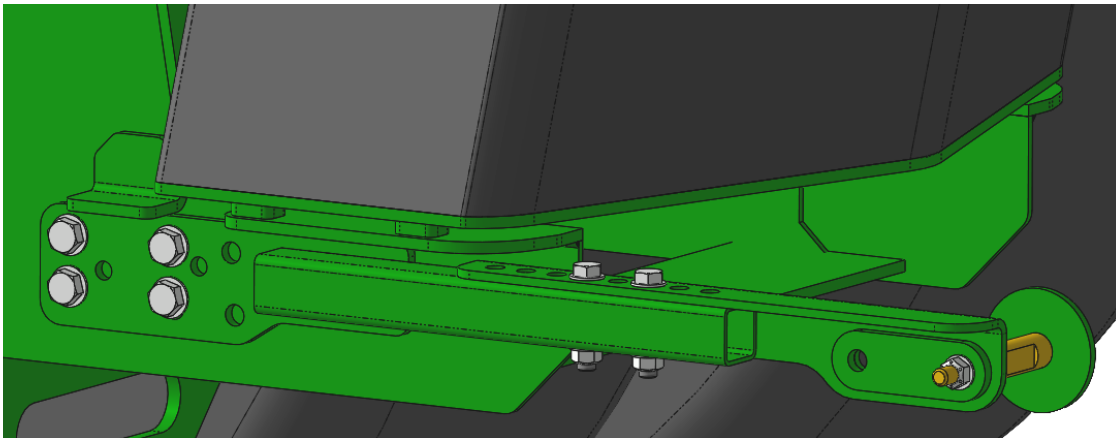

Figure 12

